

# ULTIMA Line Grip

## Basic Grip Operation

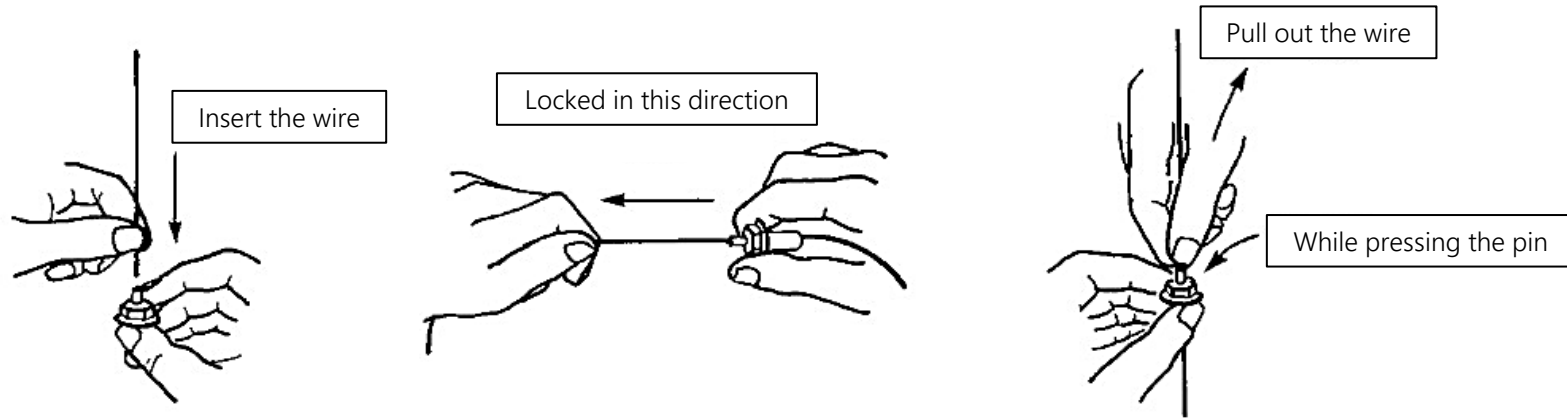

## Grip Strength

Wire	Maximum Static Load Value	Allowable Load Value
Φ1.2	1090N~1180N (111kg~120kg)	390N (40kg or less)
Φ1.5	1670N~1880N (170kg~192kg)	540N (55kg or less)

\* The maximum static load value is the maximum value when a stainless wire (7 x 7) is used for the grip in a stationary state and pulled until the wire breaks (when it breaks).

\* The allowable load is calculated with a safety factor of approximately 1/3 of the maximum static load value, but the safety factor should be considered depending on the conditions of use.

\* The maximum static load value varies depending on the type of wire used. Please contact us if you have any questions.

# ULTIMA Line Grip

---

## ▣ Attention

- The grips have a strong locking force, so it may take more force to unlock them after a load is applied, but even if they are released strongly, the locking function will not be affected again.
- Because the grips have an internal mechanism, the torque value is lower than that of normal bolts. Do not over-tighten.
- If the cut end of the wire is untwisted, it will be difficult to get into the grip. Make sure the wire is cleanly cut and twisted.
- Cut the wires cleanly and twist them into the grips to ensure smooth insertion.
- Cut the excess wire that comes out of the grip, leaving 40 to 50 mm of excess wire. Please note that if the excess wire is forced and bent, it may affect the locking function.
- For safety reasons, do not use damaged or bent wires.
- Do not apply paint or oil to this product.
- U-grips are designed with a limited wire diameter for safety, even though the external shape is the same. Please note the part number when ordering. For improvement, the shape and specifications are subject to change without notice.
- Do not use any wire other than the special wire provided by our company.
- Standard wire grip dimensions are L=1,000 and 1,500. Please consult us for other dimensions.
- Allowable load for stainless wire specifications: 55 kg for  $\phi$ 1.5 and 40 kg for  $\phi$ 1.2. Allowable load for coated wire specification: 10kg for  $\phi$ 1.2